

WESCO®

ANIXTER



MORE +
EDUCATION SOLUTIONS

We build, connect, power and protect the world.

FOCUS ON UNDERSTANDING YOUR NEEDS

Education facilities are evolving to cater to changes in technology and student behavior, while presenting new opportunities for improved learning outcomes, enhanced campus safety and the optimization of energy efficiency and operational costs. You'll find an experienced partner with WESCO|Anixter, as we support you in safer, smarter and more productive operations.

Education Facility Solutions

We address the foundations of campus interoperability that can provide agility for budgets, scalability for demand and flexibility for technology choices. This approach addresses the five key technology areas and integrates innovative solutions to meet your assessment and deployment needs.

1. Risk Management

Higher education facilities contain complex areas that require special attention and integration into an overall risk management strategy. A 24/7 crime prevention and public safety strategy is crucial to proactively maintain a safe and secure environment.

2. Network Performance

A high-performance structured cabling system plays an essential role in operating a modern campus environment, including new learning models, wireless connectivity and increased bandwidth requirements.

3. Student Experience

Adequate bandwidth and wireless coverage is needed to support the new ways people consume information, mobile device dependency and innovative learning environments.

4. Space Utilization

There is an increased demand for multipurpose areas that can be configured for different activities and controlled for comfort, safety and efficiency. Flexible facilities enhance the productivity of students as well as faculty and staff.

5. CIoT Enablement

Enabling the Campus Internet of Things (CIoT) allows you to analyze your environment and make real-time adjustments to improve productivity and efficiency.

What Is a Smart Campus Video



Our customers include:

- K-12 school districts
- Public colleges and universities
- Private colleges and universities
- Higher education medical centers

WESCO|Anixter can provide solutions anywhere on your campus:

- | | |
|-----------------------|-------------------|
| • Athletic facilities | • Libraries |
| • Auditoriums | • Office spaces |
| • Classrooms | • Outdoor areas |
| • Data centers | • Physical plants |
| • Dining halls | |
| • Dormitories | |

E-commerce

WESCO:

Access thousands of products – with photos and specifications – and streamline ordering with easy-to-use features on [Buy.WESCO.com](#).

- | | |
|---------------------------------------------|-------------------------------|
| • Fast product search | • Comprehensive order history |
| • Price and availability | • Flexible payment methods |
| • Images and full specification information | • Quote request |
| • Customized shopping lists | • In-stock flag |
| • Quick order entry | • Mini-cart |

For more information about [Buy.WESCO.com](#), visit the site, contact your local branch or call WESCO's e-commerce help desk at 866.746.3519.

Anixter:

Transaction processing is an operational necessity, but it can be a burden on cost, efficiency and time. Our web-based and mobile solutions provide 24/7 visibility into inventory, anywhere, at any time.

- | | |
|----------------------------------------------------|----------------------------------------|
| • View your specific pricing on over 300,000 parts | • User-friendly product search |
| • Check real-time inventory by location | • Filter search by product attributes |
| • Place orders and request quotes | • Download manufacturer specifications |
| • Check order status and track shipments | • 24/7 access to your Anixter account |
| • Download invoices | |
| • Manage users and account access | |

CONTRACT VEHICLES



Cooperative contracts are agreements between the government and businesses, created in order to lower the costs of procuring goods or services that multiple entities commonly need.



Contract #: PS20160



Contract #:
R170501 (Anixter)
R161701 (Anixter)
R192008 (WESCO)



Contract #121218-WES

NPPGov is a national cooperative procurement organization based in Seattle, Washington, offering publicly solicited contracts to government entities nationwide. NPPGov contracts are created through a public solicitation by a lead public agency. Access to our cooperative contract is complimentary with no purchasing obligations. Scope includes electrical products and lighting equipment.

Benefits:

- Free membership
- Available to all state and local entities
- Saves time and money
- Leverages purchasing power
- Competitively bid publicly awarded contracts

Region 4 Education Service Center Contract Available Through OMNIA Partners Cooperative Contract

OMNIA Partners, Public Sector, is the nation's largest and most experienced cooperative purchasing organization dedicated to public sector procurement. Scope includes MRO supplies, cabling, network products and solutions, and security system services.

Benefits:

- No fees to participate
- Available to state and local government entities and educational institutions in all 50 states
- Non-exclusive contracts
- No minimum purchase amounts
- No obligations
- Full catalog offering

Sourcewell Cooperative Contract

For over 40 years, Sourcewell has helped government, education, and nonprofit agencies operate more efficiently. They help save time and money with contract purchasing solutions that are solicited nationally. Scope includes MRO supplies.

Benefits:

- No fees to participate
- Available to state and local government entities and educational institutions in all 50 states
- Non-exclusive contracts
- No minimum purchase amounts
- No obligations

FOCUS ON THE EDUCATIONAL ENVIRONMENT

- 1. Outdoor and Street Lighting
 - 2. Solar Panels
 - 3. EV Charging Station
 - 4. Portable Lighting
 - 5. Emergency Call Box
 - 6. Distributed Antenna System
 - 7. Security Camera
 - 8. Portable Power
 - 9. Environmentally Controlled Cabinet
 - 10. Door Locking Solutions
- NOTE: (.....) = Network Connections

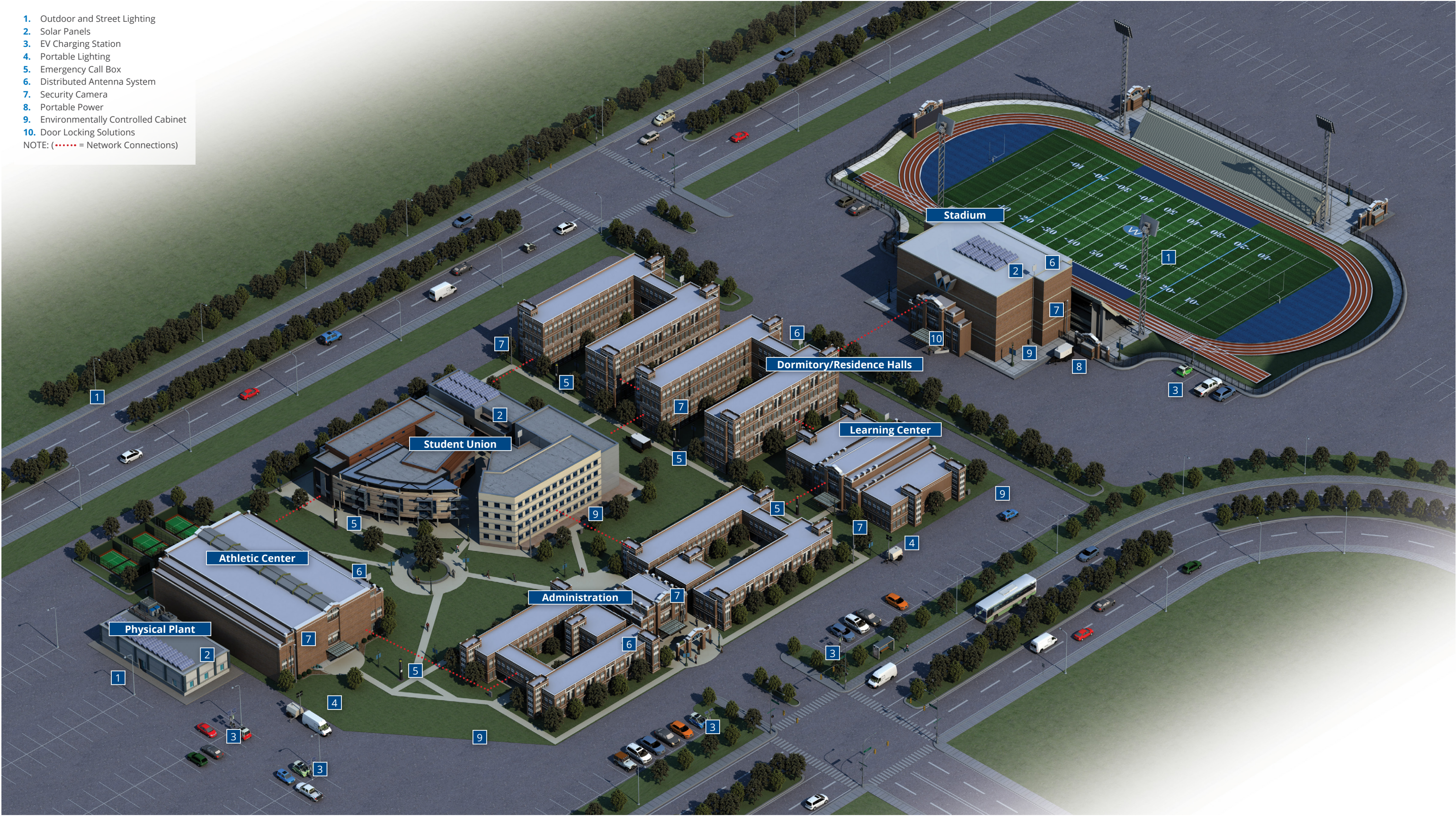

FOCUS ON SOLUTIONS TO BUILD,
CONNECT, POWER AND PROTECT



- | | | | |
|------------------------|-----------------------------------|--------------------------------|-------------------------------------------|
| 1. Disconnect Switches | 7. Boiler Room Power | 13. Uninterrupted Power Supply | 19. Waterproof Covered Outlet |
| 2. Transformer | 8. Backup Power | 14. Maintenance Area | 20. Cabinets, Cables, Networking Products |
| 3. AC Units | 9. Janitorial and Safety Supplies | 15. Chiller | 21. Handheld Printer |
| 4. Video Surveillance | 10. Motion Sensor | 16. Underground Piping | |
| 5. Cooling Tower | 11. GFCI | 17. Boilers | |
| 6. Lighting | 12. Industrial Vending Machine | 18. Pull Station | |

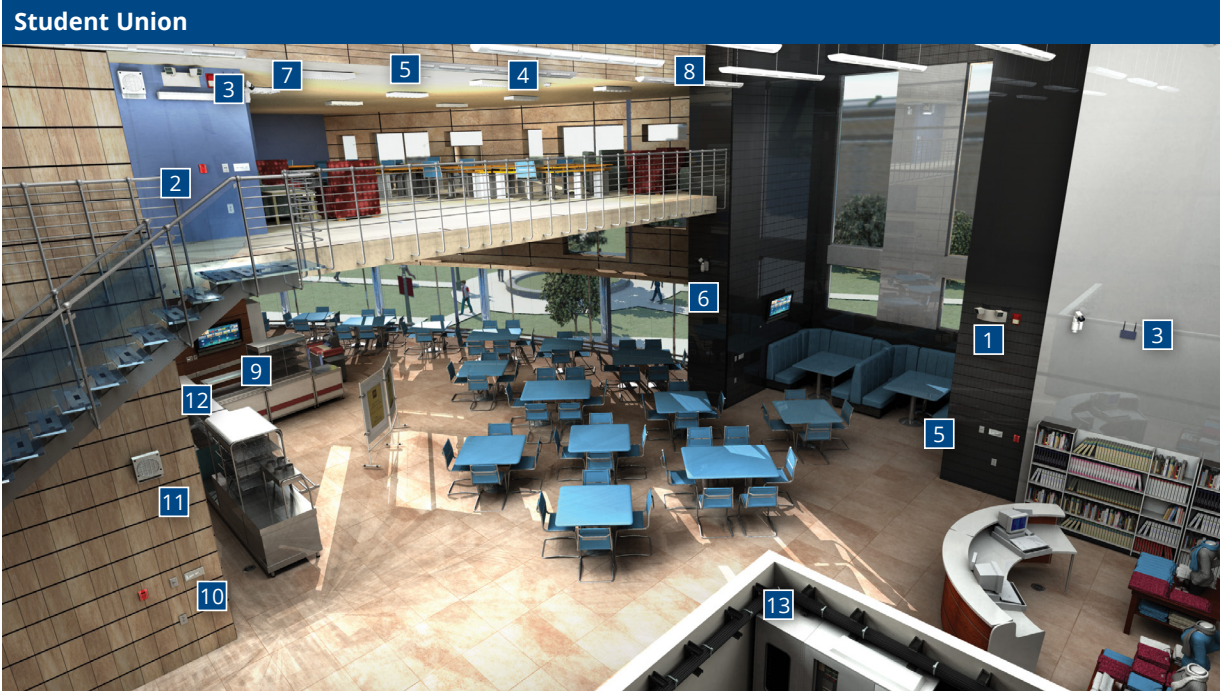

- | | | | |
|-----------------------|---------------------------------------------------------|-------------------------------------------|------------------------------|
| 1. Emergency Lighting | 6. Security Camera | 10. Receptacle and Switches | 14. Poke-Through Floor Boxes |
| 2. Pull Station | 7. Modular Surface Fixtures | 11. Sounding Device | |
| 3. Wireless Modem | 8. Alara Curv Lights | 12. Multimedia Outlets | |
| 4. Smoke Detector | 9. Metal Raceway with Network Connector and Receptacles | 13. Cabinets, Cables, Networking Products | |
| 5. Motion Sensor | | | |

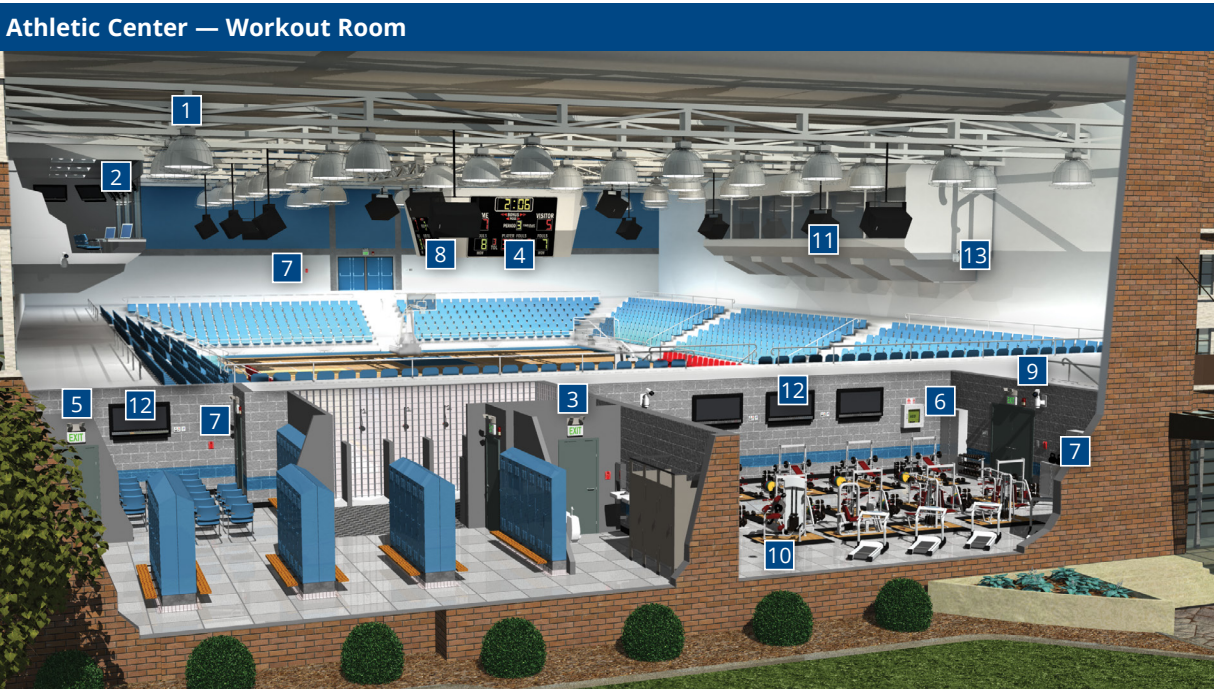

- | | | | |
|-------------------------------------------------------|----------------------|-------------------|-------------------------|
| 1. Lighting | 4. Scoreboard | 8. Key Switch | 12. HDTV Screen |
| 2. Multimedia Outlets, Network Connector, Receptacles | 5. Motion Sensor | 9. Smoke Detector | 13. Surveillance Camera |
| 3. Emergency Light and Exit Sign | 6. AED Defibrillator | 10. Floor Box | |
| | 7. Pull Station | 11. Speakers | |



- | | | | |
|----------------------|---------------------------|----------------------------------------------------|-----------------------------------------------------------|
| 1. Lighting | 6. Sounding Device | 11. Cabinets, Racks, Switches, Networking Products | 15. Audio, Network Connector, Receptacles and Data Plates |
| 2. Grounding | 7. Poke-Through Floor Box | 12. Surge Strip | 16. HDTV Display |
| 3. Motion Sensors | 8. Surveillance Camera | 13. Whiteboard | 17. Power Panel |
| 4. Recessed Lighting | 9. Pull Station | 14. Projector | 18. Emergency Lighting |
| 5. Intercom Systems | 10. Cable Management | | |

Dormitory Room



1. Motion Sensor

2. Smoke Detector
3. Lighting Network Connector and Power Strips

4. Surge Strip
5. Metal Raceway with Network Connector and Receptacles

Learning Center — Classroom and Computer Lab

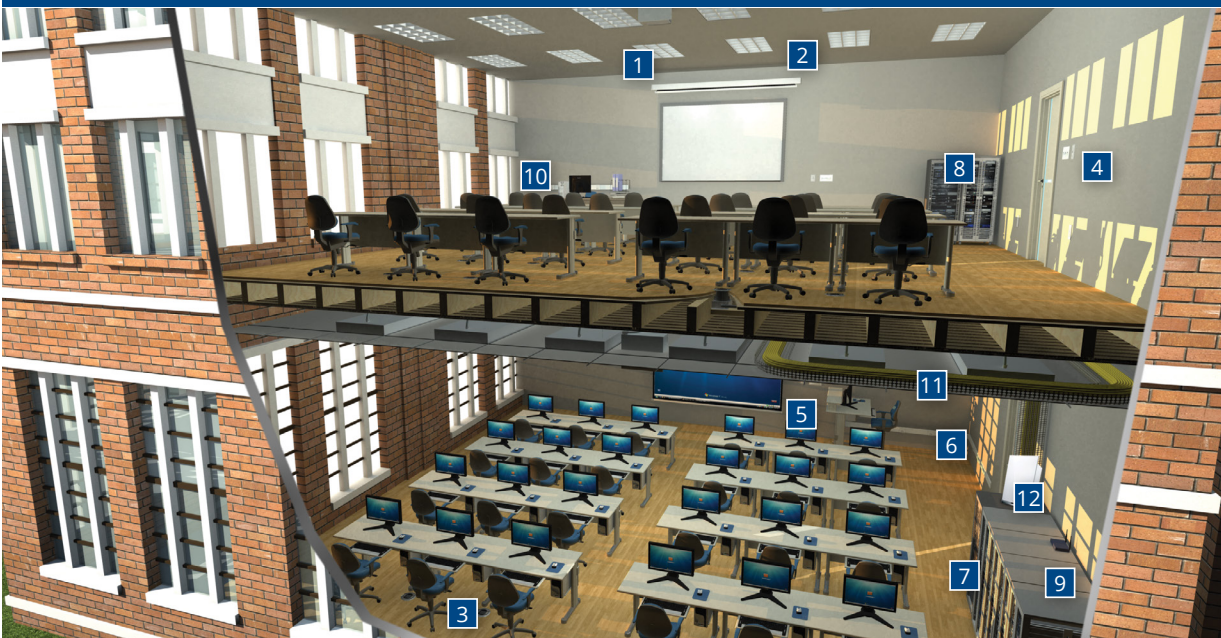

1. A/V Ceiling Enclosure

2. Modular Lighting Fixtures

3. Poke-Through Floor Boxes
4. Motion Sensor

5. Receptacle and Switches

6. Non-Metallic Raceway
7. Networking Products, Cabinets, UPS,

8. Cabinets, UPS, Fireways, Routers, Modems

9. Wireless Access Box
10. Metal Raceway with Network Connector and Receptacles

11. Cable Management

12. Air Purifier

Residence Hall Common Room



1. Decorative Lighting

2. Receptacles

3. Motion Sensors

4. Security Camera
5. Emergency Lighting Pull Station

6. Smoke Detector

7. Smoke Detector
8. Metal Raceway with Network Connector and Receptacles

9. Wireless Access Box

10. Poke-Through Floor Box
11. Multimedia Outlet

12. Sounding Device

Learning Center — Auditorium

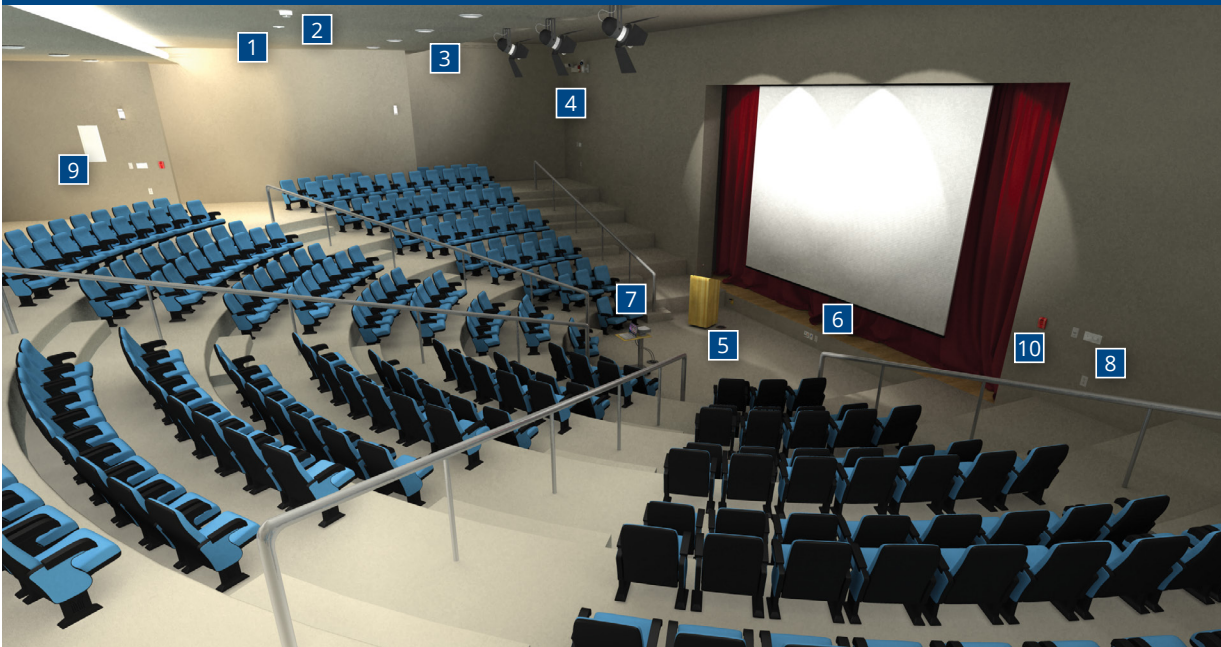

1. Motion Sensor

2. Smoke Detector

3. Recessed Lighting Fixtures
4. Emergency Lighting and Motion Surveillance

5. Poke-Through Floor Boxes
6. Multimedia Outlets

7. A/V Equipment and Projector

8. Receptacle and Switches
9. Wall Enclosure

10. Pull Station

ADOPTING A DEFENSE-IN-DEPTH
APPROACH FOR K-12

Defense in depth is a strategic approach used in a number of mission-critical environments, including data centers, hospitals and hardened facilities. Understanding and employing this approach in an education environment allows you to respond to each stage of a threat and mitigate serious harm.

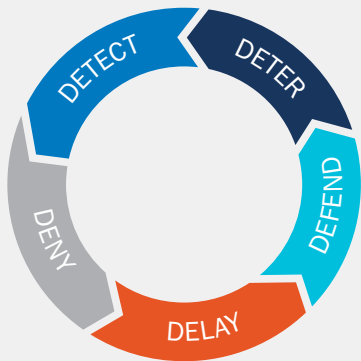

Defense in Depth (5 Ds)	Key Considerations	Technology Examples
Deter: by preventing an event from occurring	<ul style="list-style-type: none">School marshals and resource officersCrime Prevention Through Environmental Design (CPTED)Fencing and locked gates	<ul style="list-style-type: none">Vestibules/security entrancesIP video intercoms, audible deterrent alertExit-only doors with alarmsIntegrated access control with video surveillance
Detect: to quickly identify a threat	<ul style="list-style-type: none">Positively identify all visitors with expiring badgesBadging for students and faculty	<ul style="list-style-type: none">Visitor management systemsIndoor/outdoor alert systemsAlarmed exits with remote monitoringNetworked video surveillanceMetal detectors
Deny: refuse access for unauthorized personnel	<ul style="list-style-type: none">Consolidate all entryways through the main entranceDefine security policies and predator database	<ul style="list-style-type: none">Integrated access control with video surveillanceFacial recognition and object detection softwareVestibules/security entrancesRestricted key systems
Delay: by slowing, containing and isolating the threat	<ul style="list-style-type: none">Contain and isolate the intruder<ul style="list-style-type: none">Every second an intruder is delayed could save a life	<ul style="list-style-type: none">Networked and mechanical security locksPanic buttons and pagingRestricted key systemsSmoke cannons and reinforced glass
Defend: to allow for an active response	<ul style="list-style-type: none">Direct connections to authoritiesClear emergency proceduresTwo-way communication with classrooms	<ul style="list-style-type: none">Mass and emergency notificationPanic buttons and pagingNetwork door locking and safe roomsDrone surveillance and response

ABOUT US



The WESCO | Anixter Education Advantage

- Your single source for solutions
- \$2B+ total inventory for prompt fulfillment
- Same-day and next-day delivery
- 1.5M+ products
- Preferred partner to leading OEMs
- Network of 30,000 suppliers representing the industry's premium brands

Technical Excellence and Specialization

- 18,000 professionals worldwide
- Dedicated technical experts focused on the latest technologies
- Nearly 100 years of excellence and experience
- State-of-the-art lab and technology briefing centers

Global Reach, Local Expertise

- Extensive experience in serving global accounts
- More than 800 facilities around the globe
- Operations in 50+ countries and 300+ cities
- 24/7 service capability
- Serving more industry verticals than any other distributor in the world

Comprehensive Value-Added Services

- Installation
- Materials management
- Kitting and labeling
- Customized MRO solutions
- Onsite job trailer solutions
- End-to-end supply chain management
- Project management and execution across the project life cycle

Smart, Digital Solutions

- Global e-commerce platforms
- Vendor-managed inventory (VMI)
- Point-of-use systems
- Digital investments: last mile optimization, supply chain engineering, intelligent automation
- Insights from an extensive digital ecosystem and technology partnerships

E-commerce

- Access essential details, including price, UOM, specs and product images
- Over 300,000 SKUs
- Our digital capabilities are expanding to serve the growing demand for online sourcing, product information and purchasing options, so you can save time and increase efficiency



50+
COUNTRIES

MORE THAN
300
CITIES

18,000+
PROFESSIONALS
WORLDWIDE

FORTUNE
500
COMPANIES

\$16
BILLION
IN SALES*

NEARLY
100 YEARS
OF EXCELLENCE
AND EXPERIENCE

* Pro Forma 2020 Net Sales